

HX Desk Monitor Arm

Standard 2-Piece Desk Clamp

This is the most common option



- This is the most common option.
- It can slide on from back or side of desk.
- It can also disassemble to attach when no space behind desk is available.
- Requires space under desk.
- Works with wide variety of desk sizes and shapes.
- Also available as accessory.

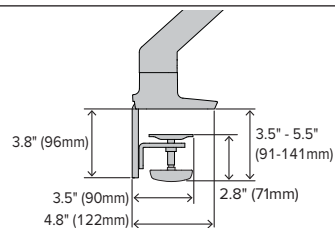
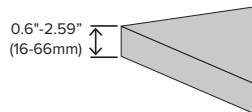
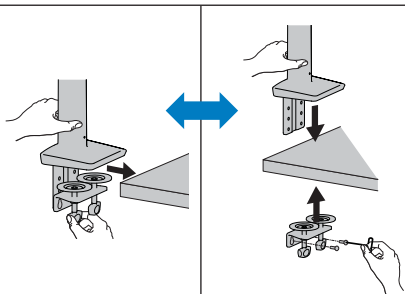

C-Clamp (under mount)

Less common option

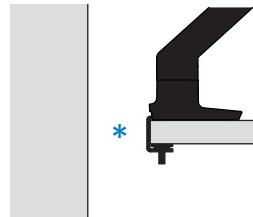

- Used in Pro-office furniture systems.
- Use when the space for clamp under desk is very limited.
- * Requires 1.2" (31 mm) from edge of desk to slide on from the back or can slide on from the side if possible.
- Also available as accessory.
- Has 0.8" (2cm) setback from edge of desk to allow room for divider panels.

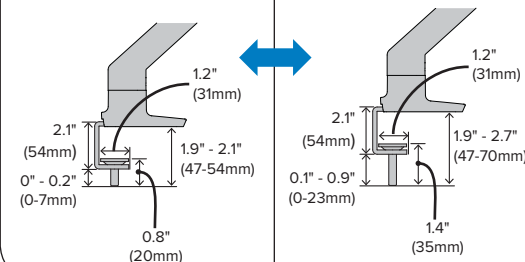
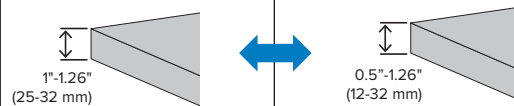
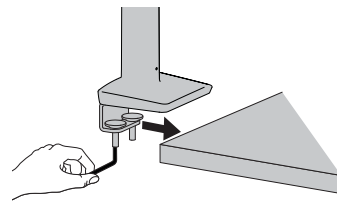

C-Clamp (top mount)

Less common option

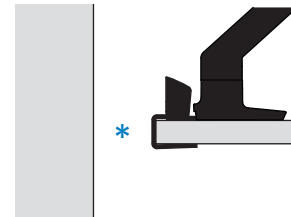

- Used in Pro-office furniture systems.
- Use when there is a need to attach clamp from above the desk.
- Use when the space for clamp under desk is very limited.
- * Requires open space from edge of desk to slide on from the back or can slide on from the side if possible.
- Also available as accessory.
- Has 0.8" (2cm) setback from edge of desk to allow room for divider panels.

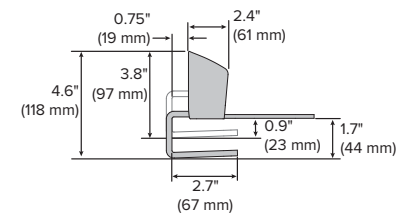
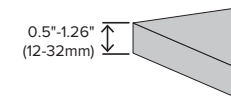
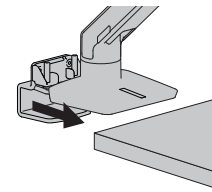

Grommet Mount

Included in some products

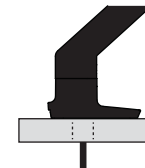

- Use when mounting to edge of desk is not available or not preferred.
- Use when base does not reach edge of desk when monitors are in desired location.
- Also available as accessory.

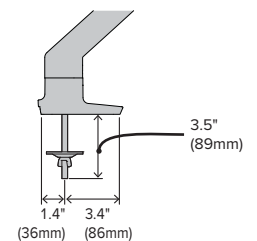
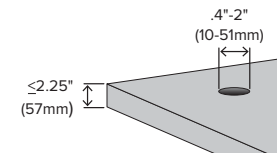
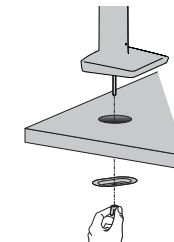

HOW TO CHOOSE YOUR DESK ATTACHMENT

LX Desk Mount Monitor Arm and LX Desk Dual Direct Arm

Standard 2-Piece Desk Clamp

This is the most common option

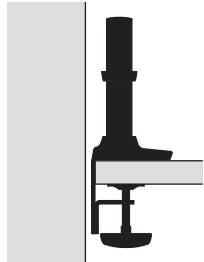

- This is the most common option.
- It can slide on from back or side of desk.
- It can also disassemble to attach when no space behind desk is available.
- Requires space under desk.
- Works with wide variety of desk sizes and shapes.
- Also available as accessory.

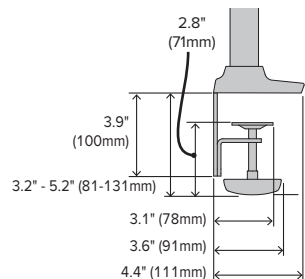
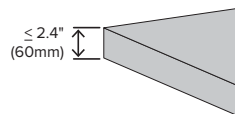
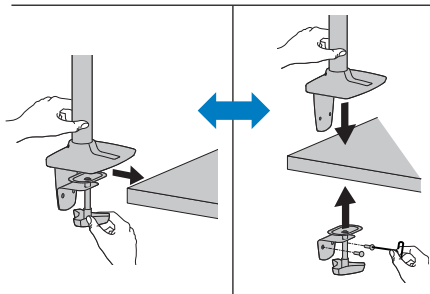

C-Clamp (under mount)

Less common option

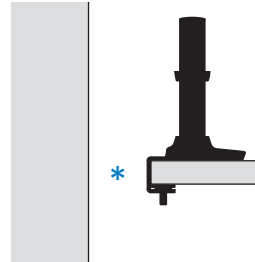

- Used in Pro-office furniture systems.
- Use when the space for clamp under desk is very limited.
- * Requires 1.2" (31 mm) from edge of desk to slide on from the back or can slide on from the side if possible.
- Also available as accessory.
- Has 0.8" (2cm) setback from edge of desk to allow room for divider panels.

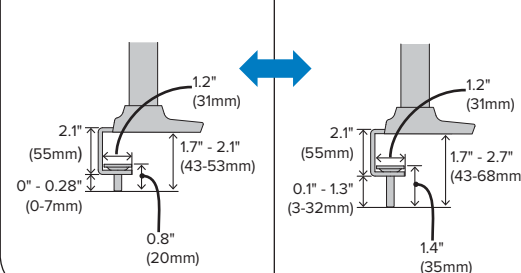
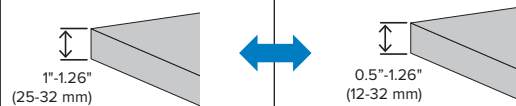
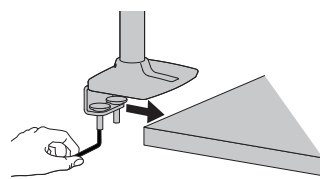

C-Clamp (top mount)

Less common option

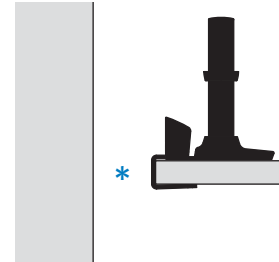

- Used in Pro-office furniture systems.
- Use when there is a need to attach clamp from above the desk.
- Use when the space for clamp under desk is very limited.
- * Requires open space from edge of desk to slide on from the back or can slide on from the side if possible.
- Also available as accessory.
- Has 0.8" (2cm) setback from edge of desk to allow room for divider panels.

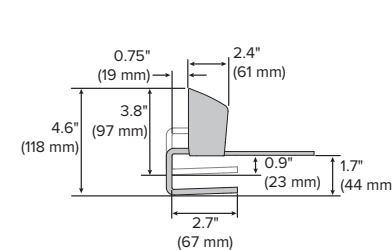
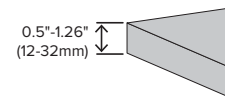
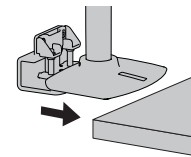

Grommet Mount

Included in some products

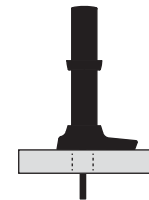

- Use when mounting to edge of desk is not available or not preferred.
- Use when base does not reach edge of desk when monitors are in desired location.
- Also available as accessory.

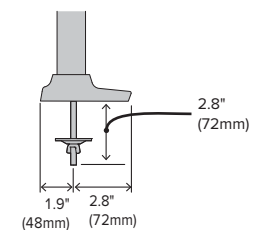
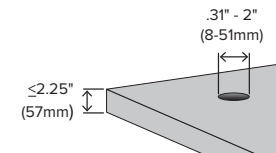
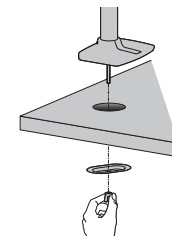

HOW TO CHOOSE YOUR DESK ATTACHMENT

LX Dual Side-by-Side Arm, LX Dual Stacking Arm and LX Desk Monitor Arm, Tall Pole

Standard 2-Piece Desk Clamp

This is the most common option

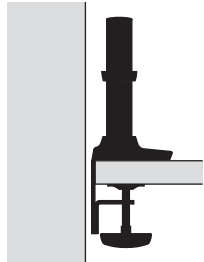

- This is the most common option.
- It can slide on from back or side of desk.
- It can also disassemble to attach when no space behind desk is available.
- Requires space under desk.
- Works with wide variety of desk sizes and shapes.
- Also available as accessory.

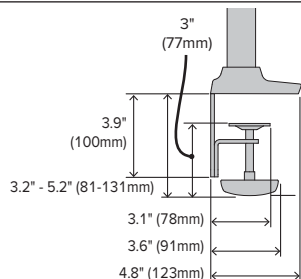
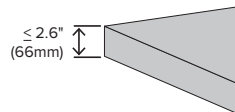
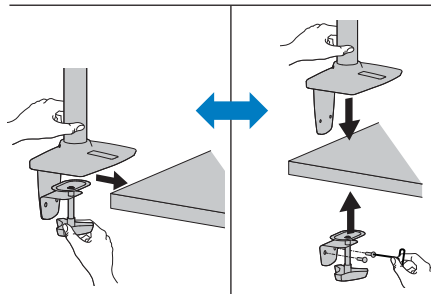

C-Clamp (under mount)

Less common option

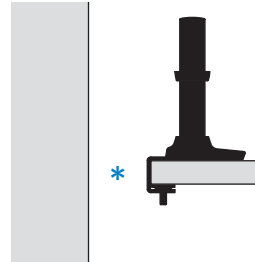

- Used in Pro-office furniture systems.
- Use when the space for clamp under desk is very limited.
- * Requires 1.2" (31mm) from edge of desk to slide on from the back or can slide on from the side if possible.
- Also available as accessory.
- Has 0.8" (2cm) setback from edge of desk to allow room for divider panels.

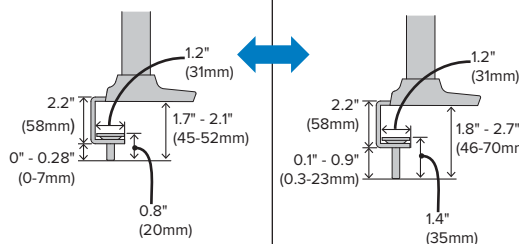
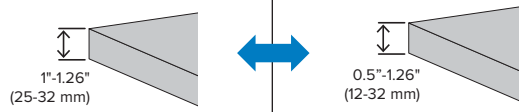
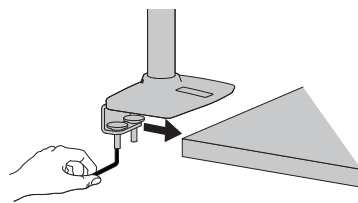

C-Clamp (top mount)

Less common option

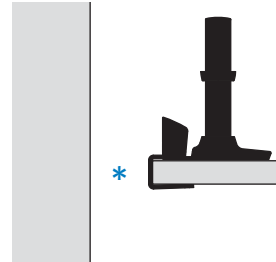

- Used in Pro-office furniture systems.
- Use when there is a need to attach clamp from above the desk.
- Use when the space for clamp under desk is very limited.
- * Requires open space from edge of desk to slide on from the back or can slide on from the side if possible.
- Also available as accessory.
- Has 0.8" (2cm) setback from edge of desk to allow room for divider panels.

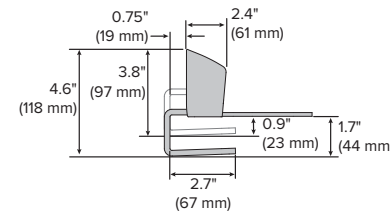
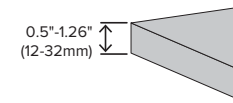
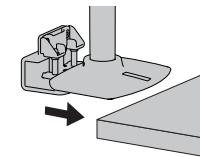

Grommet Mount

Included in some products

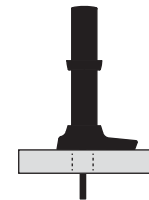

- Use when mounting to edge of desk is not available or not preferred.
- Use when base does not reach edge of desk when monitors are in desired location.
- Also available as accessory.

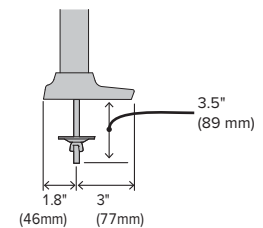
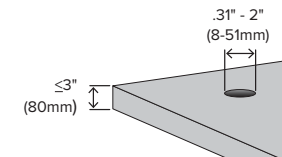
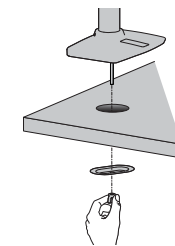

HOW TO CHOOSE YOUR DESK ATTACHMENT

MXV Desk Monitor Arm

Standard 2-Piece Desk Clamp

This is the most common option

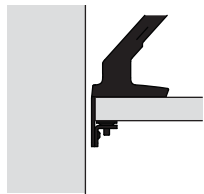

- This is the most common option.
- It can slide on from back or side of desk.
- It can also disassemble to attach when no space behind desk is available.
- Requires space under desk.
- Works with wide variety of desk sizes and shapes.
- Also available as accessory.

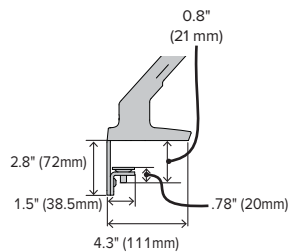
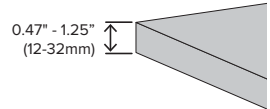
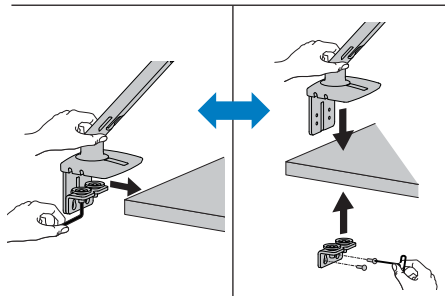

C-Clamp (under mount)

Less common option

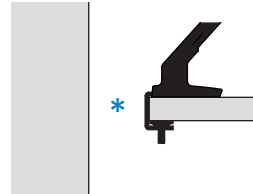

- Used in Pro-office furniture systems.
- Use when the space for clamp under desk is very limited.
- * Requires 1.2" (31 mm) from edge of desk to slide on from the back or can slide on from the side if possible.
- Also available as accessory.
- Has 0.8" (2cm) setback from edge of desk to allow room for divider panels.

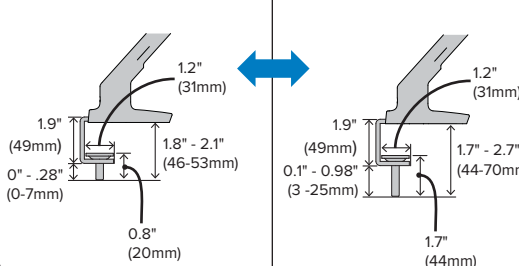
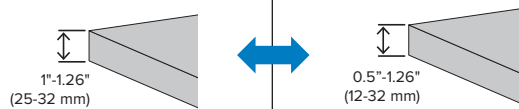
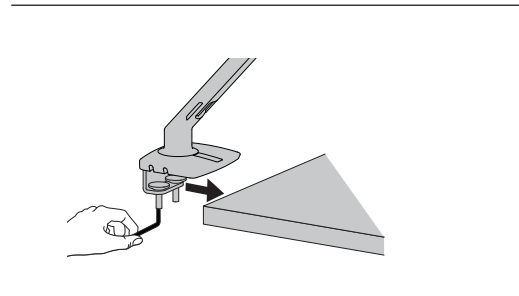

C-Clamp (top mount)

Less common option

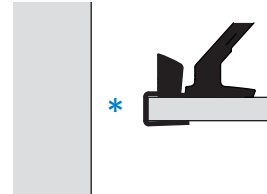

- Used in Pro-office furniture systems.
- Use when there is a need to attach clamp from above the desk.
- Use when the space for clamp under desk is very limited.
- * Requires open space from edge of desk to slide on from the back or can slide on from the side if possible.
- Also available as accessory.
- Has 0.8" (2cm) setback from edge of desk to allow room for divider panels.

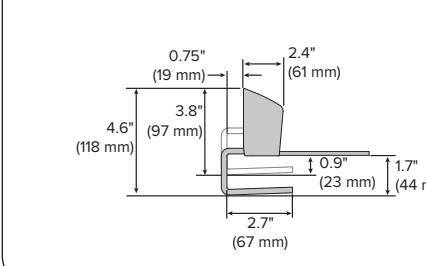
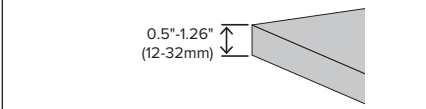
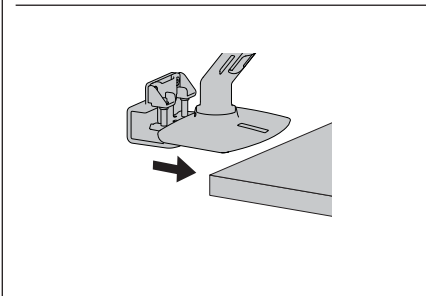

Grommet Mount

Available only as accessory

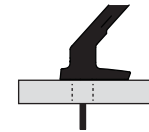

- Use when mounting to edge of desk is not available or not preferred.
- Use when base does not reach edge of desk when monitors are in desired location.
- Available only as accessory.

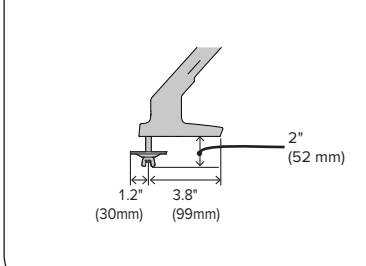
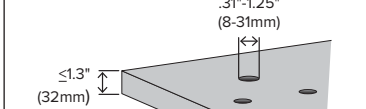
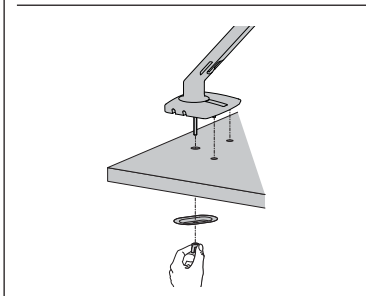

HOW TO CHOOSE YOUR DESK ATTACHMENT

MXV Dual Monitor Arm

Standard 2-Piece Desk Clamp

This is the most common option

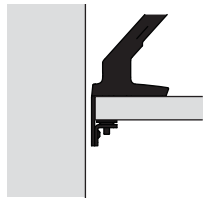

- This is the most common option.
- It can slide on from back or side of desk.
- It can also disassemble to attach when no space behind desk is available.
- Requires space under desk.
- Works with wide variety of desk sizes and shapes.
- Also available as accessory.

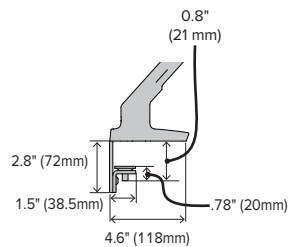
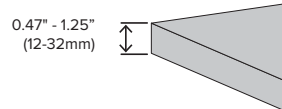
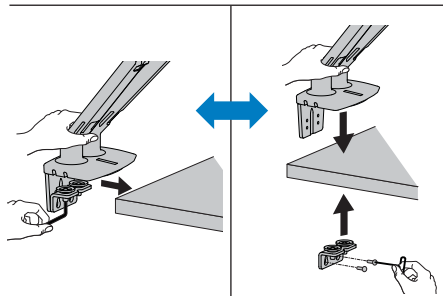

C-Clamp (under mount)

Less common option

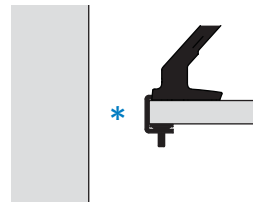

- Used in Pro-office furniture systems.
- Use when the space for clamp under desk is very limited.
- * Requires 1.2" (31 mm) from edge of desk to slide on from the back or can slide on from the side if possible.
- Also available as accessory.
- Has 0.8" (2cm) setback from edge of desk to allow room for divider panels.

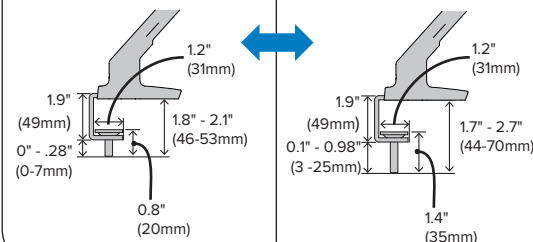
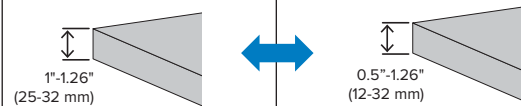
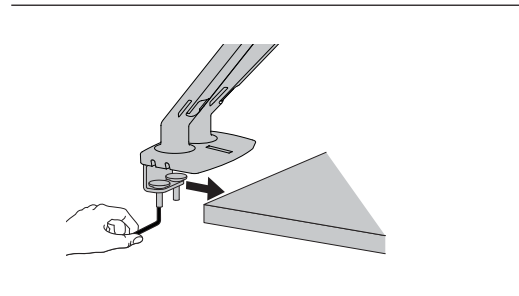

C-Clamp (top mount)

Less common option

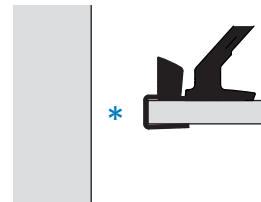

- Used in Pro-office furniture systems.
- Use when there is a need to attach clamp from above the desk.
- Use when the space for clamp under desk is very limited.
- * Requires open space from edge of desk to slide on from the back or can slide on from the side if possible.
- Also available as accessory.
- Has 0.8" (2cm) setback from edge of desk to allow room for divider panels.

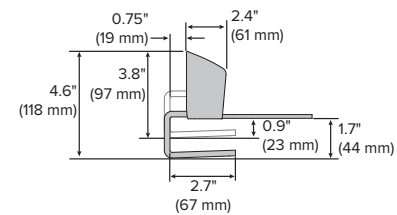
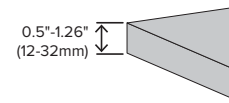
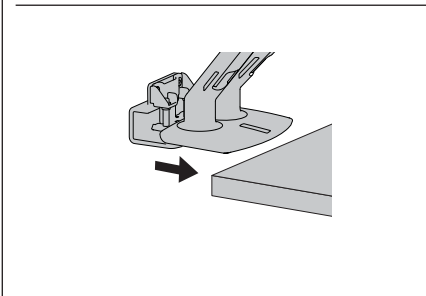

Grommet Mount

Available only as accessory

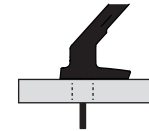

- Use when mounting to edge of desk is not available or not preferred.
- Use when base does not reach edge of desk when monitors are in desired location.
- Available only as accessory.

