

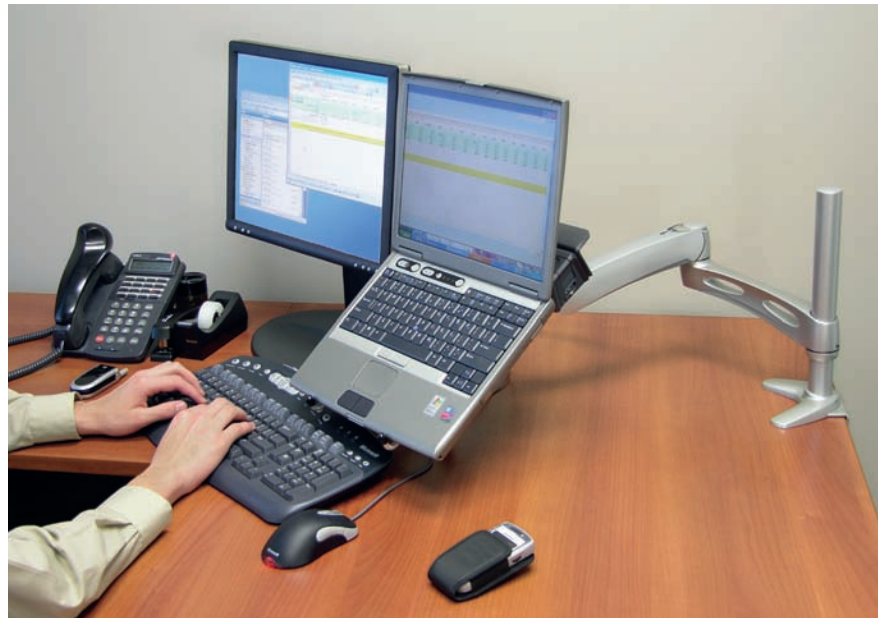

Ergotron® LX

Notebook Desk Mount Arm and LX Dual Arm



Highlights

- Constant Force (CF™) patented lift-and-pivot motion technology produces smooth adjustment
- Position your notebook screen for maximum ergonomic comfort to relieve eye, neck and back strain
- Free up a significant area of unused work space
- 33 cm (13") vertical range
- Internal cable management routes cables neatly under arm
- Easy set-up and use
- 5 year warranty



More motion. Less effort. Feel the difference.

Make the most of your valuable workspace with Ergotron's LX Desk Mount Arms. Lifting your notebook computer and/or display off the desktop reclaims workspace and positions the screen to relieve eye, neck and back strain. Choose between our single or dual arm configurations. These ingenious accessories enable you to customize your workspace to meet your specific needs. Create a productive side-by-side dual display solution or simply lift your notebook computer off a desktop for more comfortable viewing.

- Save cost by eliminating the expense of an extra screen or
- Create a productive side-by-side dual display configuration
- Effortlessly lift your notebook to eye level for maximum ergonomic comfort
- Free up your work surface
- Share your notebook display
- Use notebook with or without docking station
- Compatible with standard notebooks and convertible tablet computers



Enhance productivity by increasing monitor screen space with our dual arm configuration.



Lift both the notebook computer and docking station off the workspace to reclaim valuable surface area.

Cables are guided along underside of arm for a clutter-free work area.



LX Notebook Arm mounting plate can be adjusted to fit a variety of notebook computer sizes.



Attach LX Notebook Arm at any height on pole.



Desk clamp base uses little space yet ensures stability even as notebook is adjusted. (Shown in black.)

Range of Motion

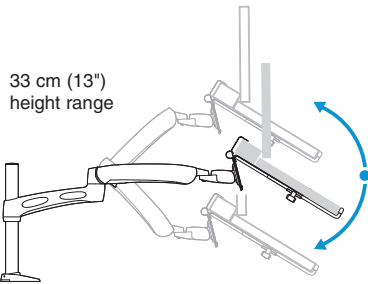

33 cm (13") height range

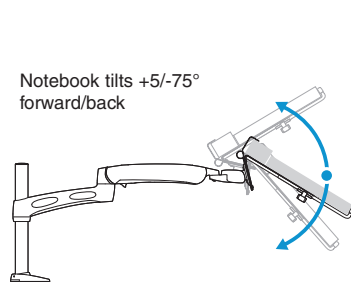

Notebook tilts +5/-75° forward/back

Arm rotates 360° around pole; rotate inly 180° with Dual Arms

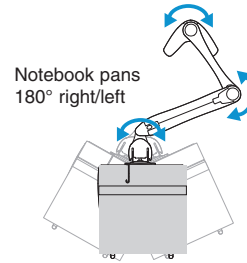

Notebook pans 180° right/left

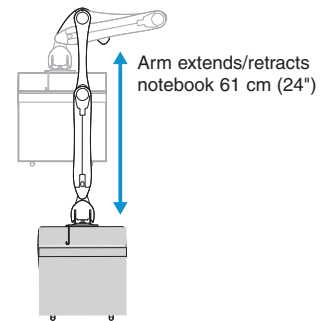

Arm extends/retracts notebook 61 cm (24")

Basic Specifications

LX Dual Desk Mount Arm (includes desk clamp, grommet mount, 1 pole, 2 LCD arms, 1 notebook tray)

Commercial Part Number: 28-512-194 (silver)
28-512-195 (black)

Grommet Mount Total Weight Capacity: 18,1 kg (40 lbs)

Desk Clamp Total Weight Capacity: 9,1 kg (20 lbs)

Shipping Weight: 10,9 kg (24 lbs)

LX Desk Mount Notebook Arm (includes desk clamp, grommet mount, 1 pole, 1 LCD arm, 1 notebook tray)

Commercial Part Number: 45-192-194 (silver)
45-192-195 (black)

Weight Capacity: 1,14-5,45 kg (2.5-12 lbs)

Shipping Weight: 5 kg (11 lbs)

Warranty: 5 year

Attachment Options:

- Desk Mount (clamp and grommet bases included): clamp to surfaces 12,7–47,6 mm (1/2–1-7/8") thick or grommet mount through holes 7,9–51 mm (5/16–2") wide and up to 63,5 mm (2-1/2") thick.

© 2007 Ergotron, Inc.
rev. 05/02/2007 870-05-062

Content is subject to change without notification.

Ergotron Europe
Beeldschermweg 3
NL-3821 AH Amersfoort
The Netherlands
Tel: +31 33 45 45 600
Fax: +31 33 45 45 649
info.eu@ergotron.com
www.ergotron.com

